

To Let

Prime Retail Unit

Queen Street, Belfast



- Landmark student housing building offering retail accommodation on part ground floor
- 340 beds on the upper floors with a further 1,000+ within one minutes' walk
- Located on Queen Street, an established City Centre retail and office location
- In close proximity to the new University of Ulster Campus
- Ideal for a restaurant/café or a range of retail or financial uses, subject to planning permission

Savills Belfast

1st Floor Lesley Studios
32/36 May Street
Belfast BT1 4NZ

+44 (0) 28 9026 7820

savills.ie



Location

Queen Street, Belfast is located in the City Centre in close proximity to Belfast City Hall. Surrounding occupiers include Ground Espresso, Boots, Caffè Nero and Centra.

The surrounding area is undergoing a significant resurgence with three student housing developments providing in excess of 1,300 beds within less than a minute walk from the unit. Further office development on Wellington Street will significantly improve the area also.

Description

The property will provide retail accommodation at ground floor with extensive frontage to Queen Street. The unit will be finished to developer's shell to include fully glazed shop front.

Accommodation

The unit provides the following approximate areas:

Floor	Sq ft	Sq m
Ground Floor	1,940	180

Lease Details

Rent: £45,000 pax

Term: 10 years, subject to 5 yearly upwards only rent reviews on a full repairing and insuring basis

Repairs & Insurance: Tenant is responsible for internal repairs and insurance

Rates Assessment

We are advised by Land and Property Services that the property is to be reassessed upon completion of refurbishment works.

Further Information/ Viewings

Colleen Fox

+44 (0) 28 9026 7826

colleen.fox@savills.ie

VAT

All prices, outgoings and rentals are exclusive of, but may be liable to Value Added Tax

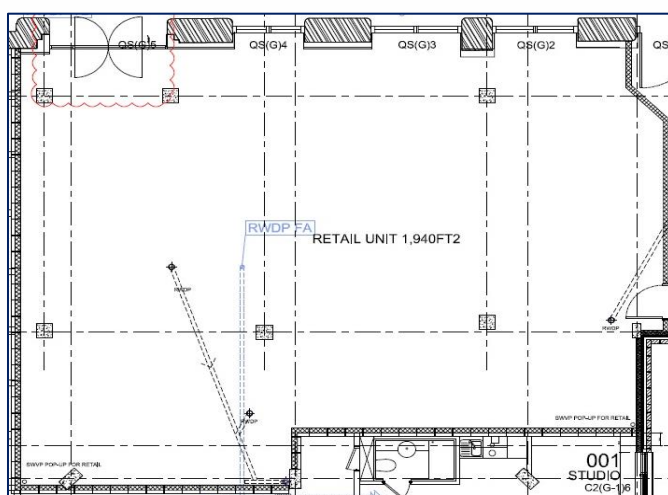

Important Notice

Savills, their clients and any joint agents give notice that:

1. They are not authorised to make or give any representations or warranties in relation to the property either here or elsewhere, either on their own behalf or on behalf of their client or otherwise. They assume no responsibility for any statement that may be made in these particulars. These particulars do not form part of any offer or contract and must not be relied upon as statements or representations of fact.
2. Any areas, measurements or distances are approximate. The text, photographs and plans are for guidance only and are not necessarily comprehensive. It should not be assumed that the property has all necessary planning, building regulation or other consents and Savills have not tested any services, equipment or facilities. Purchasers must satisfy themselves by inspection or otherwise.